

# SL2900

**Sliding Thermal  
Insulating System**

for hyper performances.



## System Identity

The Aluminco SL2900 is a top performing sliding system with innovative and unique features, offering elegant constructions and satisfying large-scale requirements.

The art of minimal architectural design with first in class performance in terms of thermal insulation, air- and water-tightness, and the value-added SOFT CLOSE function, are some of the reference points that dominate and make the SL2900 unique.

The minimalistic look of the system is determined by the minimal profile face width in the centre section and an outer frame concealed in the attachment to the building structure while the fully integrated threshold option allows easy passage and maximizes user comfort.

Aside from the design, the SL2900 is the only system that combines the ease of operation of lift-slide systems with the tight seal provided by tilt & slide elements. The latter is thanks to a continuous sealing system all around the perimeter, which saves large amounts of energy.

Thanks to innovative SOFT CLOSE function the system's sash slows down during closing and guided reliably into the end position, minimising the risk of injury and of damage to the window elements.

This top-ranked system belongs to the new generation of architectural Aluminco systems, which are based on modern architectural trends, incorporating cutting-edge technology whilst offering unrivaled functionality, with unprecedented for its time performances.

## Features & Benefits

- Top level thermal insulation thanks to the 24 mm reinforced polyamides.
- Exceptional performance in water and air tightness.
- Ability to use triple glazing for optimal sound reduction and maximum energy saving.
- Maximum transparency and light penetration thanks to face width of 64 mm and a concealed outer frame.
- The use of a concealed mechanism, the SOFT CLOSE damper, prevents damage caused by improper operation when opening or closing the slide sash and protects against any risk of injury.
- Suitable for covering large openings, with a maximum height of 2.5 m and width of 5 m, retaining their functionality and credibility.
- The sliding hardware can reliably withstand sash weights of as much as 250 Kgr.
- Three different track options offer ideal solutions depending on operational needs and performance levels.
- Smooth and easy operation of the system, even in demanding dimensions and robust constructions, is achieved because of the unique mechanism which guides the sash more gently and harmoniously into the locking position.

## Configurations

### Sliding with fixed

1Leaf with fixed, 2Leaf with fixed



FLAT

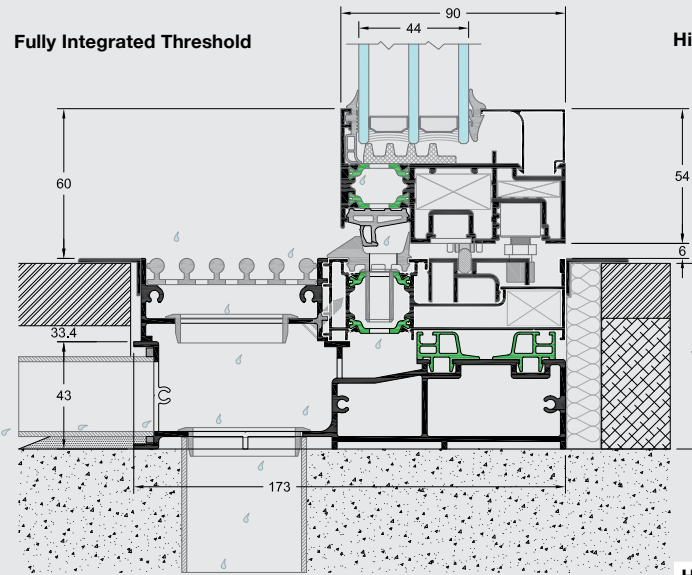

### Upgrade Threshold

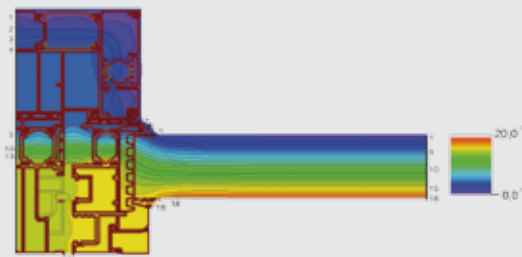
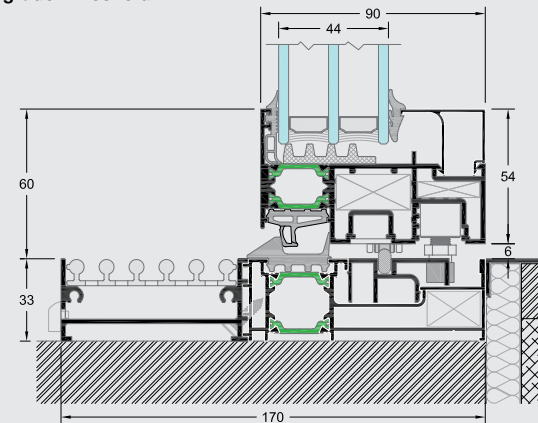

### Rate of Insulation

**$U_w=0.89 \text{ W/m}^2\text{K}$**

Thermal conductivity coefficient has calculated for the construction:

5000x2500 with  $U_g=0.5 \text{ W/m}^2\text{K}$

Glass type: 4/16 (ARGON) /4/16 (ARGON) /4

High Level Threshold

### High Level Threshold

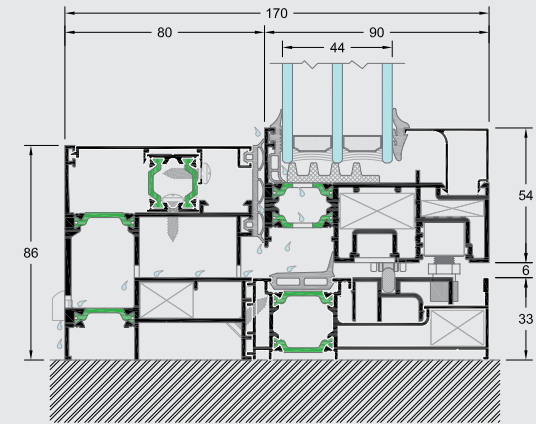

### HARDWARE

SLIDING WITH DIVERSION

**POLYAMIDES mm** 20-24

### SYSTEM PROFILE DIMENSIONS

MIN RAIL WIDTH mm 170  
MIN FRAME HEIGHT mm 86  
MIN FACE HEIGHT mm 54  
GLASS THICKNESS mm 44-74

### CONSTRUCTION DIMENSIONS

SASH WIDTH mm 680-2500  
SASH HEIGHT mm 1200-2500  
MAX. SASH DIMENSIONS mm (WxH) 2500x2500  
MAX. SASH WEIGHT mm Kgr 250

### CERTIFICATES/PERFORMANCES

AIR PERMEABILITY EN 12207 N/A  
WATER TIGHTNESS EN 12208 N/A  
RESISTANCE TO WIND LOAD EN 12210 N/A  
BURGLAR RESISTANCE N/A  
SOUND REDUCTION  $R_w$  EN 140-3 N/A  
THERMAL INSULATION  $U_f$  ISO 10077-2 2.0-4.5  $\text{W/m}^2\text{K}$

### High Level Threshold

The high level threshold solution offers maximum performance meeting effectively even the most demanding needs.

### Upgrade Threshold

The upgrade threshold option offers a rise of only 33 mm and is well suited for renovation projects.

### Fully Integrated Threshold

The fully integrated option allows easy passage and maximum convenience. This element hand in hand with the visual effect of no frames creates the ultimate minimalistic appearance.